

Biodiversity Values Map and Threshold Report

This report is generated using the Biodiversity Values Map and Threshold (BMAT) tool. The BMAT tool is used by proponents to supply evidence to your local council to determine whether or not a Biodiversity Development Assessment Report (BDAR) is required under [the Biodiversity Conservation Regulation 2017 \(Cl. 7.2 & 7.3\)](#).

The report provides results for the proposed development footprint area identified by the user and displayed within the blue boundary on the map.

There are two pathways for determining whether a BDAR is required for the proposed development:

1. Is there Biodiversity Values Mapping?
2. Is the 'clearing of native vegetation area threshold' exceeded?

Biodiversity Values Map and Threshold Report		
Date of Report Generation		05/06/2025 12:48 PM
1. Biodiversity Values (BV) Map - Results Summary (Biodiversity Conservation Regulation Section 7.3)		
1.1	Does the development Footprint intersect with BV mapping?	no
1.2	Was <u>ALL</u> BV Mapping within the development footprinted added in the last 90 days? (dark purple mapping only, no light purple mapping present)	no
1.3	Date of expiry of dark purple 90 day mapping	N/A
1.4	Is the Biodiversity Values Map threshold exceeded?	no
2. Area Clearing Threshold - Results Summary (Biodiversity Conservation Regulation Section 7.2)		
2.1	Size of the development or clearing footprint	859.7 sqm
2.2	Native Vegetation Area Clearing Estimate (NVACE) (within development/clearing footprint)	142.2 sqm
2.3	Method for determining Minimum Lot Size	LEP
2.4	Minimum Lot Size (10,000sqm = 1ha)	225 sqm
2.5	Area Clearing Threshold (10,000sqm = 1ha)	2,500 sqm
2.6	Does the estimate exceed the Area Clearing Threshold? (NVACE results are an estimate and can be reviewed using the Guidance)	no
REPORT RESULT: Is the Biodiversity Offset Scheme (BOS) Threshold exceeded for the proposed development footprint area?		no
(Your local council will determine if a BDAR is required)		

What do I do with this report?

- If the result above indicates the BOS Threshold has been exceeded, your local council **may require** a Biodiversity Development Assessment Report with your development application. Seek further advice from Council. An accredited assessor can apply the Biodiversity Assessment Method and prepare a BDAR for you. For a list of accredited assessors go to: <https://customer.lmbc.nsw.gov.au/assessment/AccreditedAssessor>.
- If the result above indicates the BOS Threshold has not been exceeded, you may not require a Biodiversity Development Assessment Report. This BMAT report can be provided to Council to support your development application. Council can advise how the area clearing threshold results should be considered. Council will review these results and make a determination if a BDAR is required. Council may ask you to review the area clearing threshold results. You may also be required to assess whether the development is “likely to significantly affect threatened species” as determined under the test in Section 7.3 of the *Biodiversity Conservation Act 2016*.
- If a BDAR is not required by Council, you may still require a permit to clear vegetation from your local council.
- If **all** Biodiversity Values mapping within your development footprint was less than 90 days old, i.e. areas are displayed as dark purple on the BV map, a BDAR may not be required if your Development Application is submitted within that 90 day period. Any BV mapping less than 90 days old on this report will expire on the date provided in Line item 1.3 above.

For more detailed advice about actions required, refer to the **Interpreting the evaluation report** section of the [Biodiversity Values Map Threshold Tool User Guide](#) .

Review Options:

- If you believe the Biodiversity Values mapping is incorrect please refer to our [BV Map Review webpage](#) for further information.
- If you or Council disagree with the area clearing threshold estimate results from the NVACE in Line Item 2.6 above (i.e. area of Native Vegetation within the Development footprint proposed to be cleared), review the results using the [Guide for reviewing area clearing threshold results from the BMAT Tool](#).

Acknowledgement

I, as the applicant for this development, submit that I have correctly depicted the area that will be impacted or likely to be impacted as a result of the proposed development.

Signature: _____

(Typing your name in the signature field will be considered as your signature for the purposes of this form)

Date: _____

05/06/2025 12:48 PM

Biodiversity Values Map and Threshold Tool

The Biodiversity Values (BV) Map and Threshold Tool identifies land with high biodiversity value, particularly sensitive to impacts from development and clearing.

The BV map forms part of the Biodiversity Offsets Scheme threshold, which is one of the factors for determining whether the Scheme applies to a clearing or development proposal. You have used the Threshold Tool in the map viewer to generate this BV Threshold Report for your nominated area. This report calculates results for your proposed development footprint and indicates whether Council may require you to engage an accredited assessor to prepare a Biodiversity Development Assessment Report (BDAR) for your development.

This report may be used as evidence for development applications submitted to councils. You may also use this report when considering native vegetation clearing under the State Environmental Planning Policy (Biodiversity and Conservation) 2021 - Chapter 2 vegetation in non-rural areas.

What's new? For more information about the latest updates to the Biodiversity Values Map and Threshold Tool go to the updates section on the [Biodiversity Values Map webpage](#).

Map Review: Landholders can request a review of the BV Map where they consider there is an error in the mapping on their property. For more information about the map review process and an application form for a review go to the [Biodiversity Values Map Review webpage](#).

If you need help using this map tool see our [Biodiversity Values Map and Threshold Tool User Guide](#) or contact the Map Review Team at map.review@environment.nsw.gov.au or on 1800 001 490.



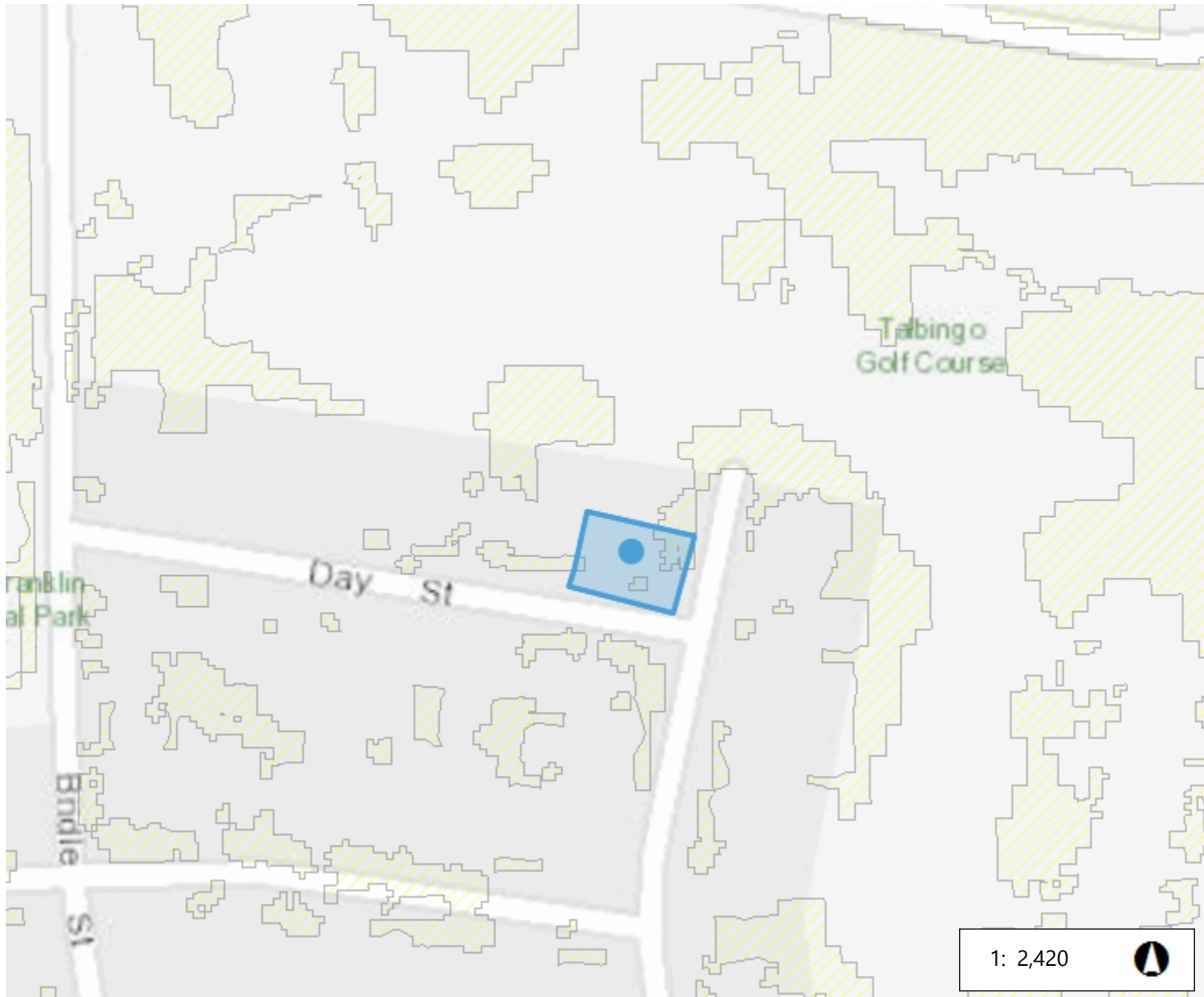

Biodiversity Values Map



123.0 0 61.48 123.0 Metres

WGS_1984_Web_Mercator_Auxiliary_Sphere

Legend

-  Biodiversity Values that have been mapped for more than 90 days
-  Biodiversity Values added within last 90 days
-  Native Vegetation Area Clearing Estimate (NVACE)
-  Development area selected by proponent

05/06/2025 12:48 PM

This map is a user generated static output from an Internet mapping site and is for reference only. Data layers that appear on this map may or may not be accurate, current, or otherwise reliable.

Imagery © Airbus DS/Spot Image 2016

© NSW Department of Customer Service, Basemaps 2019

© NSW Department of Planning and Environment

The results provided in this tool are generated using the best available mapping and knowledge of species habitat requirements.

This map is valid as at the date the report was generated. Checking the [Biodiversity Values Map viewer](#) for mapping updates is recommended.